

# JVC

## PORTABLE MINIDISC PLAYER

ENGLISH



MDLP

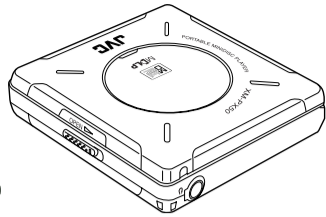

\* This unit has been manufactured with great precision. Applying a strong shock to the unit or dropping it may cause a failure. For example, if you sit down with the unit into a back pocket of your trousers, it may exert the pressure upon the unit and may cause a failure.

### INSTRUCTIONS

LVT0593-001A[UB]

#### Supplied Accessories

Check the packing carton for these accessories.

AC adaptor (AA-R352)	1 pc.	Rechargeable nickel metal hydride battery (BN-R1210)	1 pc.
Headphones	1 pc.	Carrying pouch	1 pc.
Wired remote control	1 pc.		
Charger (AC-R127)	1 pc.		

\* Use numbers indicated in parentheses when asking for replacement parts.

Thank you for purchasing this JVC product. Please read these instructions carefully before starting operation to be sure to obtain optimum performance and a longer service life from your minidisc player.

**CAUTION!**  
THIS PRODUCT UTILIZES A LASER.  
USE OF CONTROLS OR ADJUSTMENTS OR PERFORMANCE OF PROCEDURES OTHER THAN THOSE SPECIFIED HEREIN MAY RESULT IN HAZARDOUS RADIATION EXPOSURE.  
DO NOT OPEN COVERS AND DO NOT REPAIR YOURSELF. REFER SERVICING TO QUALIFIED PERSONNEL.

**WARNING:**  
TO REDUCE THE RISK OF FIRE OR ELECTRIC SHOCK, DO NOT EXPOSE THIS APPLIANCE TO RAIN OR MOISTURE.

**CAUTION:**  
AC adaptor (AA-R352), Charger (AC-R127) and rechargeable Ni-MH battery (BN-R1210 and BN-R127) are audio equipments for XM-PX50 only.

\* MDLP features a new sound compression method (ATRAC3) and a 2 times (or 4 times) long-hour stereo recording and playing function.  
The MDLP logo is marked on the MD recorders and players compatible with MDLP. It is also marked on MDs prerecorded in ATRAC3 (excluding recordable MDs).

\* Do not block the ventilation opening or holes. (If the ventilation openings of holes are blocked by a newspaper or cloth, etc., the heat may not be able to get out.)  
Do not place any naked flame sources, such as lighted candles, on the apparatus.  
When discarding batteries, environmental problems must be considered and local rules or laws governing the disposal of these batteries must be followed strictly.  
Do not use this apparatus in a bathroom or places with water. Also do not place any containers filled with water or liquids (such as cosmetics or medicines, flower vases, potted plants, cups, etc.) on top of this apparatus.

**CLASS 1**  
**LASER PRODUCT**

1. CLASS 1 LASER PRODUCT
2. **CAUTION:** Invisible laser radiation when open and interlock failed or defeated. Avoid direct exposure to beam.
3. **CAUTION:** Do not open the top cover. There are no user serviceable parts inside the Unit; leave all servicing to qualified service personnel.

**CAUTION:** Invisible laser radiation when open and interlock failed or defeated. AVOID DIRECT EXPOSURE TO BEAM. (e)

**WARNING:** Osynlig laserstrålning när denna del är öppnad och spärren är urkopplad. Beträkta ej strålen. (s)

**ADVARSEL:** Usynlig laserstrålning ved åbning, når sikkerhedsafbrydere er ude af funktion. Undgå udsættelse for stråling. (d)

**VARO:** Avattaessa ja suo-  
jälukitus ohitettaessa olet alttiina näkymättömälle laserstrålulle. Älä katso säteeseen. (f)

**WARNING LABEL, PLACED INSIDE THE UNIT**

### Power Supply Preparations

#### Using the rechargeable Ni-MH battery (included)

##### 1 Remove the rechargeable battery from its case.

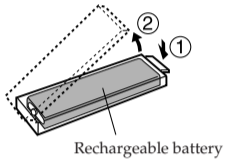

##### 2 Insert the rechargeable battery into the minidisc player.

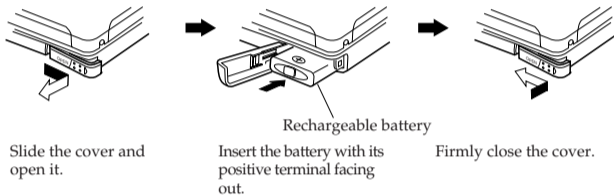

##### 3 Connect the AC adaptor to the charger and the AC outlet.

##### 4 Put the minidisc player onto the charger.

Lightly push the minidisc player as shown to securely place it.

Place the player in the stand with the top facing towards you.

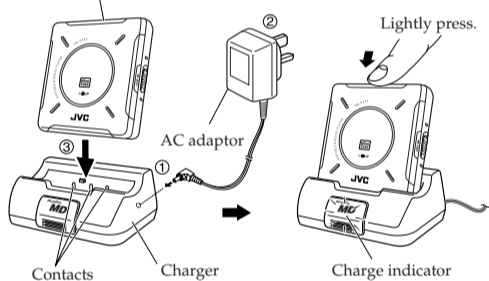

• During charging, the charge indicator lights up. Also, the minidisc player is turned on.

##### 5 When recharging is completed, the charge indicator goes out.

##### Remove the minidisc player from the charger.

While holding the charger by hand, raise the minidisc player straight up and remove it upwardly.  
• 45 seconds after completion of recharging, the minidisc player is automatically turned off.

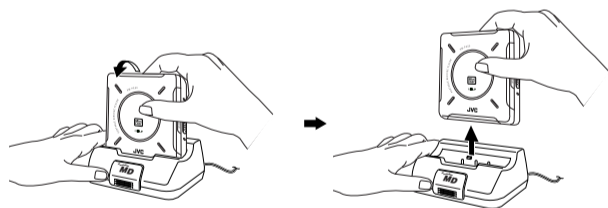

#### Notes:

- Before starting charging, always turn off the minidisc player. If you put the playing minidisc player, charging does not start.
- It takes approximately 3.5 hours to recharge the rechargeable battery.
- The rechargeable battery has a service life of approximately 300 charge-discharge cycles. If the operating time on one full charge becomes noticeably shorter than it used to be, the battery has reached the end of its service life and should be replaced.
- The AC adaptor and rechargeable battery may become warm while recharging. This is not a malfunction.
- When the minidisc player without the rechargeable battery is put on the charger, do not play it. Otherwise, a malfunction may occur.
- During charging, the charge indicator may blink for connection check. The battery indicator may also blink.
- At the moment when the minidisc player is placed onto the charger, something may appear on the display panel or a mechanical sound may be issued for approx. 1 second. However, this is not a malfunction.

#### Accidental Operation Prevention Function (Hold Mode)

This function prevents the minidisc player from operating accidentally.

Both minidisc player and remote control have HOLD switches to set in HOLD mode, each of which works independently.

[Unit (Bottom view)]

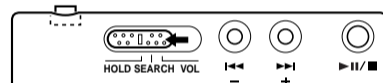

[Remote control]

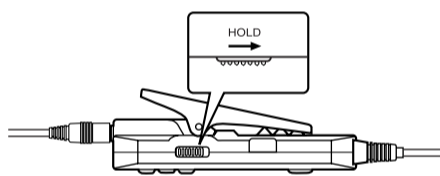

In HOLD mode, no button operation is possible.

To operate the minidisc player or remote control normally, switch off the HOLD mode.

#### Battery Indicator

The battery indicator appears on the remote control display. When the indicator appears as below, power will be shut off a short while after.

Rechargeable battery: Recharge it.



#### Note:

• While "No Disc" is displayed, the battery indicator does not change. Actual indication will be made when an MD is inserted.

### Cautions

#### Batteries

• Before replacing batteries, always turn the minidisc player off. Otherwise, the settings you have made will be changed.

#### Rechargeable Ni - MH battery :

- Use only the rechargeable battery BN-R1210 (supplied) or BN-R127 (not supplied) with this minidisc player.
- If the power delivered by the battery lasts for a very short time after recharging, it means that the battery's service life is over. Do not use it any more.
- Recharging an already charged battery will shorten its service life.
- When recharging a battery for the first time, or when it has not been used for a long period of time, the play time may be shorter than usual. In a case like this, repeatedly recharge and discharge the battery. This will restore it to its regular state.
- Do not allow any metal objects to touch the terminals of the rechargeable battery because this may cause dangerous short-circuiting.
- Recharge the battery at a temperature of 10°C to 35°C.
- Charge at least once every 6 months when not using for long periods of time, to avoid a drop in battery recharging performance

#### Rechargeable battery:

To prevent damage to the battery, and to avoid electrolyte leakage, heed the following instructions.

- Align the ⊕ and ⊖ polarities properly when inserting the batteries.
- Remove the batteries if you do not plan to use the minidisc player for a long period of time.
- Do not expose the batteries to open flame, and do not short-circuit, disassemble, or subject them to excessive heat.

#### Carrying batteries:

- When putting rechargeable battery in a pocket or bag, ensure that no other metal objects, such as necklaces or coins, are placed together with them. Contact with metal may cause short-circuiting which, in turn, may cause a fire.
- Be absolutely sure to carry the rechargeable battery in the battery carrying case.

#### Recycling Notice

The rechargeable battery is designated recyclable.  
Please follow your local recycling regulations.

#### AC adaptor and charger

• Handle the AC adaptor and charger carefully. Improper handling is dangerous.

- Do not touch them with wet hands.
- Do not place heavy objects on top of them.
- Do not forcibly bend them.

- Do not short-circuit the contacts of the charger.
- Be sure to use only the AC adaptor and charger provided with this minidisc player.
- Disconnect the AC adaptor from the power outlet if the unit is not going to be used for a long time.

#### Minidisc Player Unit

- Do not alter or remodel the unit as this can cause malfunctioning.
- Do not alter or impact the unit as this may damage it.
- Do not bring a cellular phone close to the minidisc player as it may cause noise or malfunction.
- Avoid using the unit in the following locations since they can cause malfunctioning.
  1. Bathrooms and other moisture-prone places.
  2. Warehouses and other dusty places.
  3. Very hot places near heating appliances, etc.

- Do not leave the unit exposed to direct sunlight for long periods of time as this may deform or discolor the cabinet and may also cause malfunctioning.

#### Precautions for listening with the headphones

- Do not play your headset at a high volume. Hearing experts advise against continuous extended play.
- If you experience a ringing in your ears, reduce volume or discontinue use.
- Do not use while operating a motorized vehicle. It may create traffic hazard and is illegal in many areas.
- You should use extreme caution or temporarily discontinue use in potentially hazardous situations.
- Even if your headphones are an open-air type designed to let you hear outside sounds, don't turn up the volume so high that you can't hear what's around you.

#### When driving a car

- In the interest of traffic safety, do not use the minidisc player while driving a vehicle.

### Location of Controls

#### [Minidisc Player Unit]

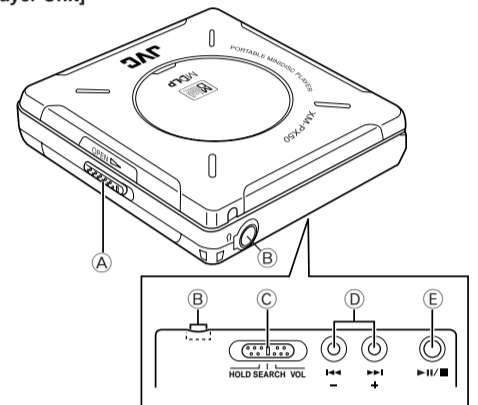

#### [Remote Control]

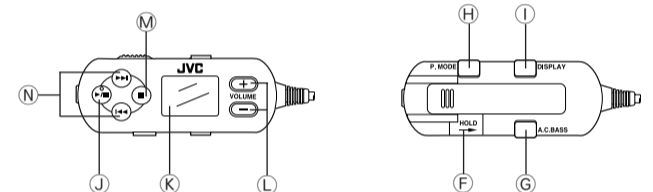

#### [Indicators on the remote control display]

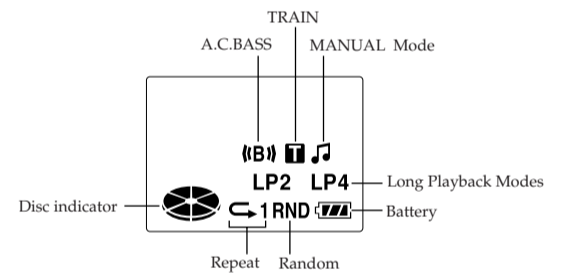

- A OPEN knob
- B Headphones jack (f)
- C HOLD / SEARCH/ VOL (Volume) Mode switch
- D Volume and Skip / SEARCH button (+, -, <<<, >>>)
- E Play / Pause / Stop button (▶||■)
- F HOLD switch
- G A.C.BASS (Active Clear Bass) button
- H P.MODE (Play mode) button
- I DISPLAY button
- J Play / Pause button (▶||■)
- K Display
- L VOLUME button (+, -)
- M Stop button (■)
- N Skip / SEARCH button (<<<▶▶▶)

### Maintenance

#### Unit:

Wipe the unit and remote control with a soft cloth. Remove stubborn dirt using a cloth which has been dipped in water (or soapy water) and wrung out. Then wipe them dry.

- If you intend to use a chemically treated cleaning cloth, read its directions first.
- Do not use alcohol or paint thinners.

#### Contacts:

If the contacts of the charger or minidisc player are dirty, charging is not mode. Clean them using a commercially available cotton swab, once a month.

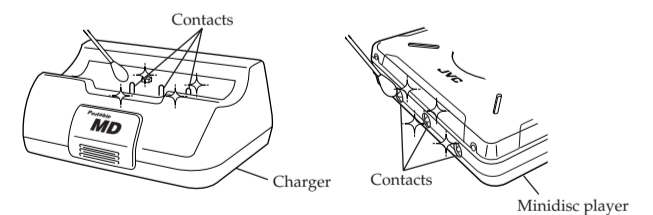

#### MDs:

If the MD cartridge is dirty wipe it with a damp cloth and then wipe dry.



#### Handling the MDs

- Do not open the shutter. The shutter is usually locked to prevent opening. Do not force in to open, or the disc may be destroyed.

- When storing MDs, avoid locations which are
  - Exposed to direct sunlight.
  - Susceptible to high levels of humidity or dust.
  - Directly exposed to heat from a heating appliance.
  - On top of a car dashboard or near the rear window.

Follow the numbers in the figure to the right.

**1 Connect the headphones plug firmly.**

**2 Connect the remote control plug firmly.**

The unit might turn on. However, when you leave the unit as it, it will automatically turn off.

**3 Make sure the switches on the unit and remote control are not on HOLD setting.**

**4 Load an MD.**

- Slide the OPEN knob to open the lid.
  - Open the lid by hand.
  - Insert the MD into the MD slot beneath the lid, with its label side facing up. Insert the MD until it stops. Be sure the  $\Delta$  or  $\Rightarrow$  mark on the MD aligns as shown in the figure.
  - Close the lid.
- "HELLO" appears on the remote control display. Then the track number and playback time appear after "T.READ" has gone out.

**5 Adjust the volume level between 0 and 25.**

Press the Volume (+, -) button on the unit or the remote control.

**6 After "HELLO" disappears, press the  $\triangleright/\parallel$  button on the remote control or the  $\triangleright/\parallel$  button on the unit.**

Playback starts from the first track and ends after playing all the tracks on the MD.

**Notes:**

- The disc indicator rotates Number of tracks being played
- Insert the MD in the way that it will not touch the catch. If the catch is bent for some reason, the lid may not be closed properly.
- When opening the lid, please hold it by the edge when an MD is already loaded.
- If no MD is loaded, "No Disc" appears on the display, and the power will automatically shut off after approx. 10 seconds.
- If the track has a title, it will appear first.
- To eject the MD, slide the OPEN knob and open the lid by hand. The MD will then come out.
- When the remote control is connected, the power may automatically turn on. However, if left as it is, it will eventually turn off automatically.
- This MD Player has a 40 second (SP mode) sound-skip-guard memory function to accommodate any shocks. Consequently, it can be used while walking.

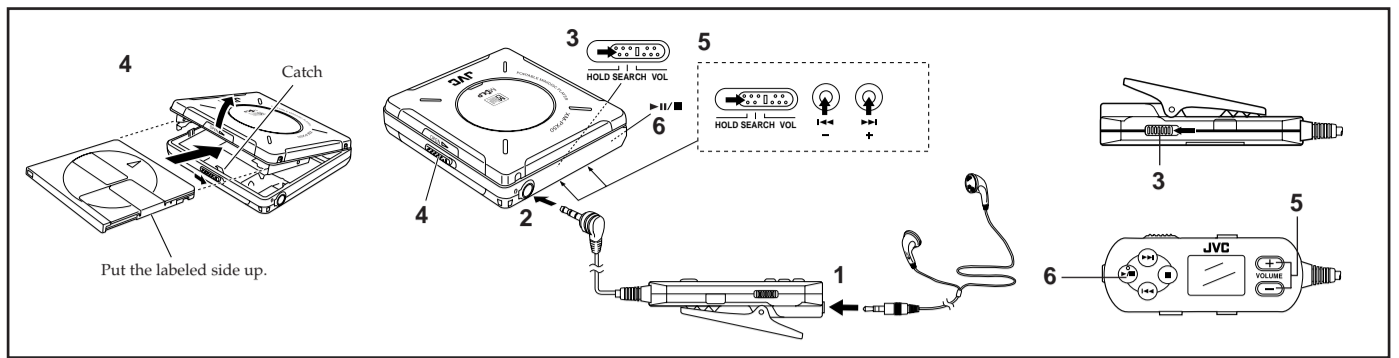

**Stereo long-hour playback**

The unit supports MDLP. So the unit can play any MD recorded in SP, LP2 or LP4 mode. When a MD recorded in LP2 or LP4 mode is played, "LP2" or "LP4" indicator lights up on the display. ("SP" is not displayed.)

- SP : Standard stereo playback (Max. 80 minutes in MD 80)
- LP2 : 2 times long-hour playback (Max. 160 minutes in MD 80)
- LP4 : 4 times long-hour playback (Max. 320 minutes in MD 80)
- MDs recorded by the MD recorder that do not support MDLP are played in standard (SP) mode.

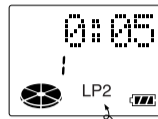

In the case of 2 times long-hour playback

**Showing the Disc Information**

Each time you press the DISPLAY button while in Stop mode or during playback, the MD's information is displayed as follows.

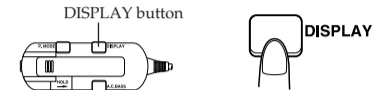

**In Stop mode:**

Disc title\*  $\rightarrow$  Total number of tracks and total playback time of the MD  $\rightarrow$  Track title\*  $\rightarrow$  Playback time  $\rightarrow$  (back to the beginning)

**During Playback:**

Playing time  $\rightarrow$  Track title\*  $\rightarrow$  (back to the beginning)

\*The disc title or track title will scroll if it consists of 7 characters or more. If no title is given, "J" appears on the display. (Up to 80 characters can be displayed.)

Operation	Button	Display/Reference
To pause play	[Unit]  or [Remote control] Press during play.	 Blinks
To stop play (Stop mode)	[Unit]  or [Remote control] Press for 1 second or more. Just press.	 Stops
To turn off the unit (Off mode)	[Unit]  or [Remote control] In play mode, press for 1 second or more.	  The power is shut off after "BYE" appears on the display. To turn on the unit, press the $\triangleright/\parallel$ (or $\triangleright/\parallel$ ) button.

Operation	Button	Display/Reference
Fast forward/Reverse	[Unit]  [Remote control]	<ul style="list-style-type: none"> <li>During Random Play, the skip buttons cannot be used to skip back to tracks that were played previously in the random sequence.</li> </ul>
	[Unit]  [Remote control]	

**Repeat Play and Random Play**

You can select either Repeat Play or Random Play. In Repeat Play, you can repeat all the tracks, or an individual track, as many times as you like. In Random Play, you can play all the tracks in random order.

**Selecting Repeat Play and Random Play in Stop mode**

In Stop mode, press the P.MODE button. Each time you press the button, the play mode changes as follows:

- $\square \rightarrow \square \rightarrow$  RND  $\rightarrow \square \rightarrow$  RND  $\rightarrow \square \rightarrow$  Original display  $\rightarrow$  (back to the beginning)
- $\square$  : Repeats 1 track.
- $\square$  : Repeats all the tracks.
- RND : Random play
- $\square$  RND : Repeats one track randomly selected.
- $\square$  RND : Repeats all the tracks in random order.

After selecting one of the above modes, press the  $\triangleright/\parallel$  (or  $\triangleright/\parallel$ ) button.

To exit Repeat Play or Random Play, stop the MD and then press the P.MODE button until the display returns to its original setting.

**Repeat Play during Playback**

**During Normal Play:**

Each time you press the P.MODE button, the play mode changes as follows:

- $\square \rightarrow \square \rightarrow$  Original display  $\rightarrow$  (back to the beginning)
- Select " $\square$ " to repeatedly play the current track. Select " $\square$ " to repeat all the tracks.

**During Random Play:**

Each time you press the P.MODE button, the play mode changes as follows:

- $\square \rightarrow \square \rightarrow$  RND  $\rightarrow \square \rightarrow$  Original display  $\rightarrow$  (back to the beginning)
- Select " $\square$  RND" to repeatedly play a randomly selected track. Select " $\square$  RND" to repeat all the tracks in random order.

To exit Repeat Play or Random Play, stop the MD and then press the P.MODE button until the display returns to its original setting.

**Selecting the Operational Options of Remote Control**

**Muting the pip tone**

When you press a button on the remote control except for the A.C.BASS and VOLUME (+, -) buttons, a pip tone is emitted.

To mute the pip tone, while pressing the A.C.BASS button in Stop mode or during playback, press the P.MODE button. "BEEP OFF" appears on the remote control display.

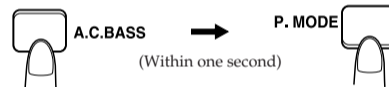

To resume the pip tone, do the same operation again. "BEEP ON" will appear on the display.

**Changing the display character contrast**

The character display contrast can be adjusted when the characters become less clear due to ambient temperature or during scrolling.

While pressing the A.C.BASS button in Stop mode or during playback, press the SEARCH button. Adjustment can be made between LCD00 and LCD15. While the SEARCH button is pressed, the contrast will be changed continuously. The initial setting is "LCD10."

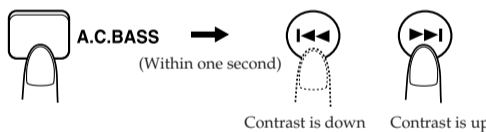

**Changing the Sound (A.C.BASS)**

Each time you press the A.C.BASS button, the sound mode name and the indicator shown on the display change as follows:



**(B) ON:** The A.C.BASS (Active Clear Bass) function is enabled and the bass level is automatically controlled in conjunction with the sound volume.

**I ON:** The amount of sound leaking from the headphones will be reduced.

**J ON:** You can use the adjusted tone. To adjust the tone, see "Adjusting Tone in MANUAL Sound Mode".

To cancel every function, press the A.C.BASS button until the display returns to the original one.

**Adjusting Tone in MANUAL Sound Mode**

You can adjust the tone by changing the bass and treble.

**1 Press the A.C.BASS button until "MANUAL" (J) appears on the display. (If the J indicator is already lit, you can skip this step.)**

**2 Press the A.C.BASS button for 2 seconds or more within 8 seconds. The following tone level meter appears.**

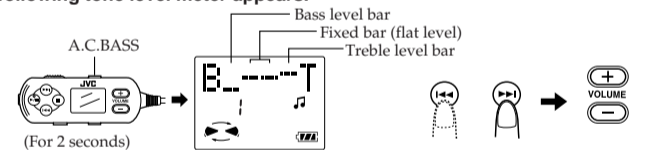

**3 To change the bass level, press the  $\lll$  button. The bass level bar blinks. Then, press the VOLUME + or - button within 16 seconds to move the bass level bar up or down (in 3 steps each).**

To change the treble level, do the same except for pressing the  $\ggg$  button. The tone level set here is stored in memory.

To exit tone adjusting mode, wait until the display automatically returns to the original one, or press the A.C.BASS button until the display returns to the original one.

**Troubleshooting Guide**

Before requesting service for this minidisc player, check the chart below for a possible cause of the problem you are experiencing. Some simple checks, or a minor adjustment on your part, may eliminate the problem and restore proper operation.

If you are in doubt about some of the check points, or if the remedies indicated in the chart do not solve the problem, refer to the directory of Authorized Service Centers (enclosed with this minidisc player), or consult your dealer for instructions.

Problem	Check this
Does not operate.	Is the MD loaded? If unloaded, "No Disc" will appear on the display.
Cannot play the MD.	<ul style="list-style-type: none"> <li>Is the HOLD switch released?</li> <li>Is the battery low?</li> <li>Is there moisture condensation on the lens? (Wait for about an hour and then try again.)</li> </ul>
Tracks on MD do not play in order, starting with the first track.	<ul style="list-style-type: none"> <li>Is the Repeat Play or Random Play selected?</li> <li>You stopped or turned off the power while playing. It changed to Resume Play.</li> </ul>
Cannot hear music—too noisy.	<ul style="list-style-type: none"> <li>Is the headphone plug inserted all the way?</li> <li>Is the plug dirty? (Wipe away dirt on the plug.)</li> <li>Is music recorded on the MD? If not, "BLANK" will appear on the display.</li> </ul>
TV picture is distorted. Radio reception is noisy.	Is the unit too near a TV or tuner? (If the TV or tuner is connected to a simple indoor antenna, connect it to an outdoor antenna.)
Power is not turned on.	With both HOLD switches activated, the battery was changed during playback. (Release both HOLD switches and try to operate again.)
Charging indicator does not light during charging.	Is the charger too hot? (If so, disconnect the AC adaptor and leave the charger for a while.)

**MD Messages:**

Messages	Meaning	Action
DISC ERROR	There is a problem (damage) with the disc.	Replace the disc.
READ ERROR	Cannot read data.	Remove the MD and reinsert it.

**Using the Minidisc Player with Optional Accessories**

**Using the minidisc player with an audio system**

You can listen to MDs through your audio system.

- After turning off the amplifier, plug a stereo connection cable (not supplied) into the headphones jack as shown below.
- Adjust the volume of the minidisc player to an appropriate level.
- Adjust the volume level on the amplifier.
- Use the unit's buttons for operation. (The remote control will issue a Pip tone.)

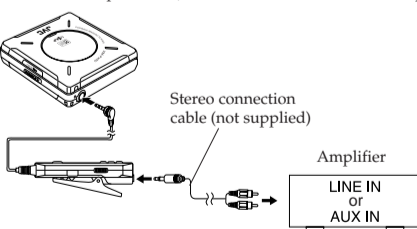

**Using the minidisc player with a car audio system**

You can listen to an MD through your car audio system. The following accessories are available for your car audio system.

- Car audio cassette adaptor

**CAUTION:**

- Connect the car audio cassette adaptor to the remote control headphone jack. The other end connects to the cassette slot of your car.
- Adjust the volume level of the unit to an appropriate level.

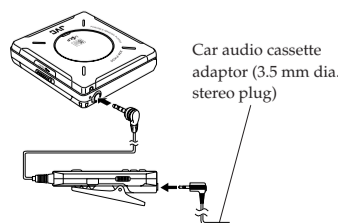

**Notes:**

- The insertion direction of the car audio cassette adaptor is limited, be sure that it can be inserted into the cassette slot of your car audio system.
- Depending on the vehicle used, noise may occur. In this case, it is recommended to connect a noise filter (available on the market) between the remote control and the car audio cassette adaptor.
- If your car audio system is equipped with a LINE IN or AUX IN jack, you can connect the output of the remote control to the jack using a stereo mini plug signal cord (not supplied). In this case, you do not need the optional car audio cassette adaptor.

**Specifications**

**Portable MINIDISC player**

- Type : Minidisc digital audio system
- Sampling frequency : 44.1 kHz
- Audio compression system : ATRAC/ATRAC 3 (MDLP)
- Numbers of channels : 2 channels (stereo)
- Frequency response : 20 Hz to 20 000 Hz
- Wow & flutter : Unmeasurable
- Output : Headphone (3.5 mm dia. stereo  $\times$  1) 5 mW/ch at 10% THD/16 ohms to 47 kohms

Volume level: VOL 12	Continuous playback time*		
	SP mode	LP2 mode	LP4 mode
Rechargeable battery (BN-R1210)	21 hours	23 hours	26 hours
Rechargeable battery (BN-R127)	18 hours	20 hours	23 hours

\* Above duration may differ depending on the ambient temperature and conditions.

- Power requirements : DC 1.2 V (rechargeable battery)
- Dimensions (L  $\times$  W  $\times$  H) : 76 mm  $\times$  17.4 mm  $\times$  81 mm (Excluding buttons and controls)
- Mass : Approx. 74 g (without battery)

**AC adaptor (AA-R352)**

- Input power source : AC 230 V, 50 Hz
- Output voltage : DC 3.5 V, 0.6 A

**Charger (AC-R127)**

- Input power source : DC 3.5 V, 0.6 A

Design and specifications are subject to change without notice.

US and foreign patents licensed from Dolby Laboratories Licensing Corporation.